



أليف

ALIF HOLDINGS
HOTEL APARTMENTS

POPULATION
11.13 million

CULTURAL CAPITAL OF
PUNJAB

18th LARGEST CITY
IN THE WORLD

ONE OF THE
WEALTHIEST
CITIES IN PAKISTAN

ESTIMATED GDP
\$65.14 billion

LAHORE

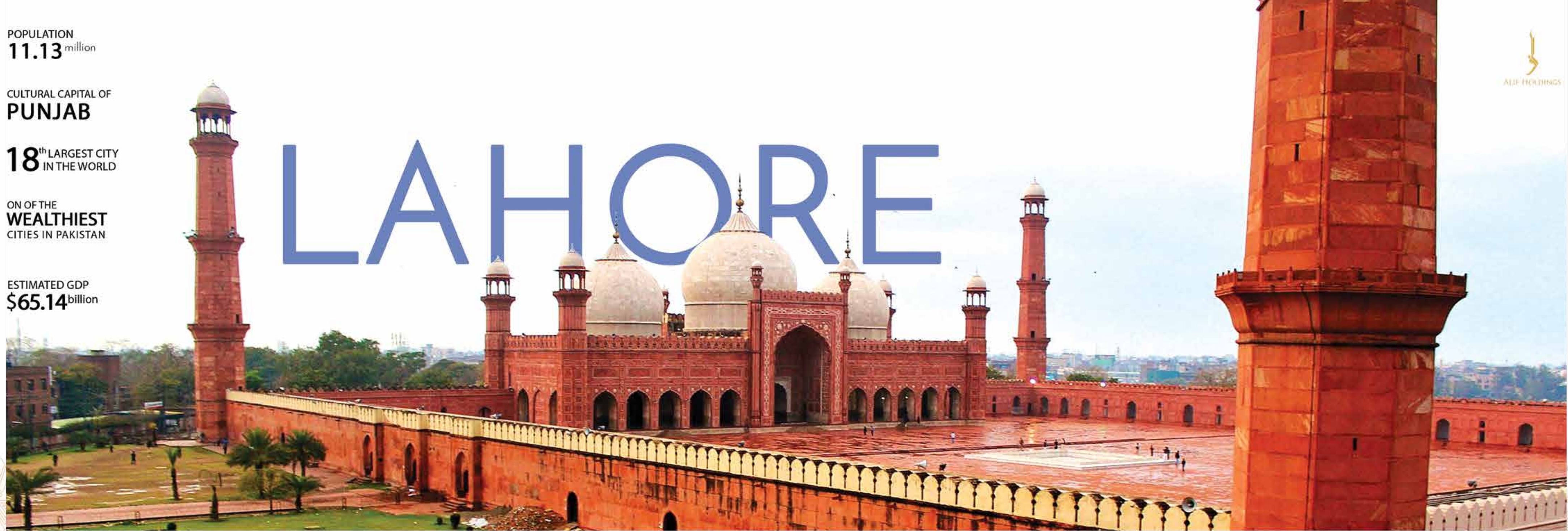



About Lahore

Lahore, widely considered the country's cultural capital, is popular for its array of tourist activities. From seeing priceless artifacts to historical sites to shopping places to a variety of restaurants, the options are endless. The city not only mediates with its historical rich past but also with the contemporary technological advancement.

Dotted with more than 60,000 restaurants, Punjab is known for its love for food. Lahore alone has more than 6,000 hotels and restaurants, according to data provided by Habibullah Khan, a member of the Lahore Restaurants Association.

He pointed out that the restaurant industry provides business to more than 40 other sectors, including packaging, delivery, agriculture, poultry, and dairy.



Lahore has developed a lot in the last few years, specially keeping the infra-structure of the city in mind. The road network has developed and new services like Metro bus service on ferozapur road and the new addition of Orange line metro train has been a remarkable addition. A lot of new grand shopping malls have been built and some are still under construction. Malls built on the international design standars have changed the shopping experience for the residents of the city and this retail sector is further showing more growth.



Muhammad Mahmood Alam Road , or more popularly known as M. M. Alam Road, is a major road in Lahore, Punjab, Pakistan named in honour of the Pakistan Air Force flying ace, Air Commodore Muhammad Mahmood Alam. The road extends from Gulberg Main Market to Firdous Market in Gulberg, and runs parallel to Gulberg Boulevard thus providing an alternate route. The road hosts a variety of flamboyant restaurants, fashion boutiques, shopping malls, beauty saloons and décor stores



Lahore accomodates a lot of software houses. IT industry in Lahore has flourished in the past years and is growing. It houses big names such as NetSol Technologies, Arbisoft, Techlogix and Arfa software technology park. Also a lot of other software houses operate on small scale all over the city. The growth in the feild of IT and technology in Lahore has remained remarkable over the years and is further growing.



Acres of beautifully landscaped luxury home development, a prestigious golf and country club, as well as a high end commercial center. Probably the most beautiful RESIDENTIAL CONFERENCE venue in Pakistan, for nature loving corporates. Built on over 100 acres of lush green and serene location on the outskirts of Lahore, ideal for Conferences, Away days, Cricket tournaments, Group lunches, Pool side dinners, Seminars, Sales trainings, Team and Capacity Building. LCountry Club is favourite venue of many multinationals, pharmaceuticals and NGO's Seeing is believing so come visit us and you be amazed. Similar clubs can be found at diferent locations in the city making it another attraction for citizens.



Bahria Town

Lahore

It is a flagship gated community in Lahore. The community is home to the Grand Jamia Mosque, Lahore which is the seventh largest mosque in the world with a total capacity of 70,000 people. After success at national level, Bahria has been featured by international magazines and news agencies, referred to as the prosperous face of Pakistan. Newsweek calls it as Pakistan's "Gateway to Paradise". On October 6, 2011, Los Angeles Times referred Bahria as "functioning state within a non-functioning one". After further development, Main boulevard of Bahria would be a major spot in future for commercial activities.

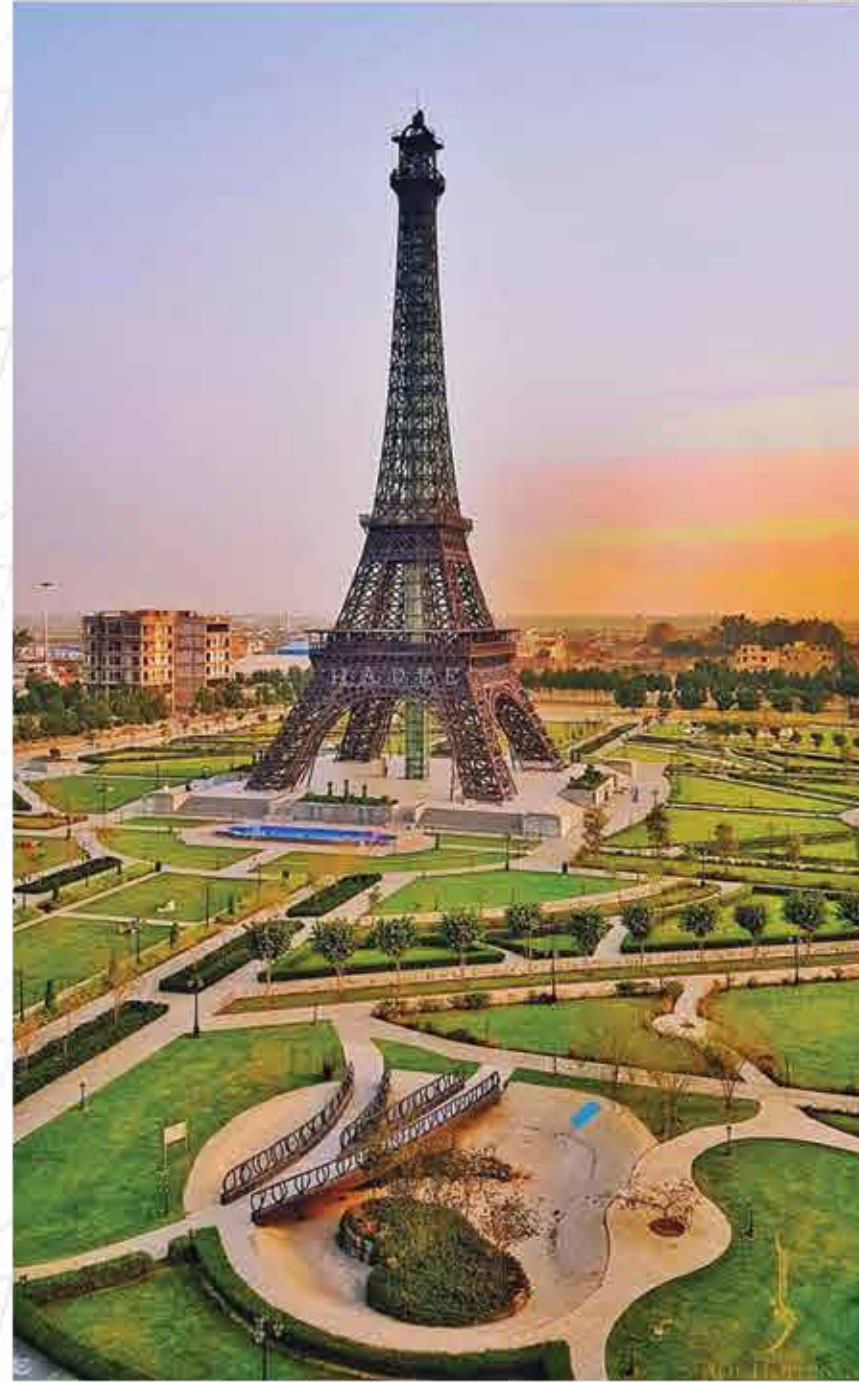
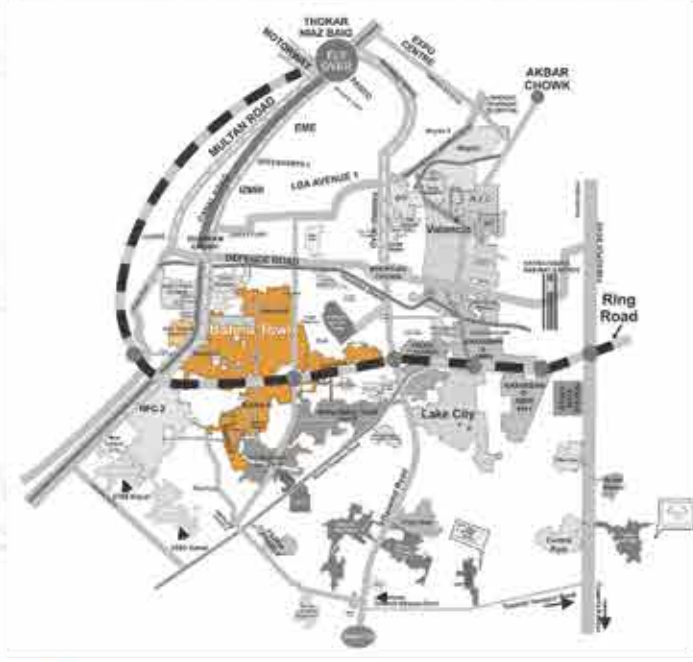

MAIN BOULEVARD PLAN

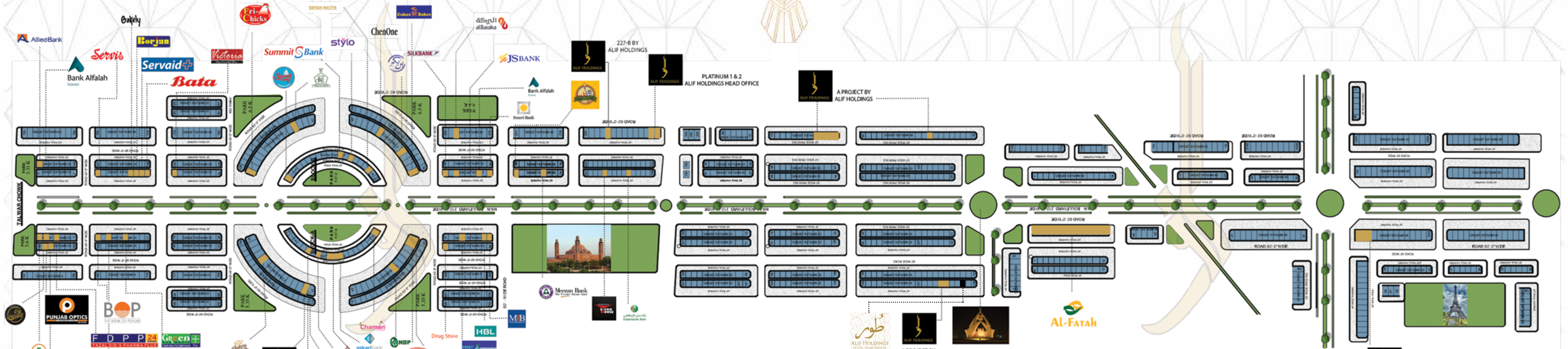

ALIF HOLDINGS

A PROJECT BY ALIF HOLDINGS

A PROJECT BY ALIF HOLDINGS

A PROJECT BY ALIF HOLDINGS AR-13

A PROJECT BY ALIF HOLDINGS



طُور

ALIF HOLDINGS

Offering One Of a Kind Hotel Apartment experience, located just 30 mins through ring road from the airport in the pristine Location of Bahria town lahore.

Feature Include

- Dedicate reception area
- Concierge Services
- Housekeeping Services
- Laundry Services
- In-room Dining
- Rooftop garden
- Spacious Parking
- Luggage handing services
- Free WiFi
- CCTV cameras

HOTEL APARTMENTS



People are choosing serviced apartments for accommodation when they move to a different place for vacation or work related stay. The reason why people choose this type of accommodation is simple, these apartments offer many advantages to travelers over expensive hotel rooms.

Feature Include

- Stylish and affordable accommodation
- Spacious Atmosphere
- Better Degree of Privacy
- Happening Location
- Safe and Clean Accommodation

36
Apartments

08
Floors

11
Shops

BASEMENT FLOOR PLAN



B.F. PROPOSAL PLAN
SCALE 3/16"=1'-0"

Shop No. 01

Total Price = **2,052,000/-**
 35% Down Payment = **718,200/-**
 After 9 months = **301,000/-**
 18 Monthly installments = **35000/-**
 On Possession = **40,2800/-**

Shop No. 02 , 03

Total Price = **1,985,400/-**
 35% Down Payment = **694,890/-**
 After 9 months = **292,000/-**
 18 Months installments = **35000/-**
 On Possession = **368,510/-**

Shop No. 04,05,06&07

Total Price = **2,376,000/-**
 35% Down Payment = **831,600/-**
 After 9 months = **349,272/-**
 18 Months installments = **35000/-**
 On Possession = **565,128/-**

GROUND FLOOR PLAN

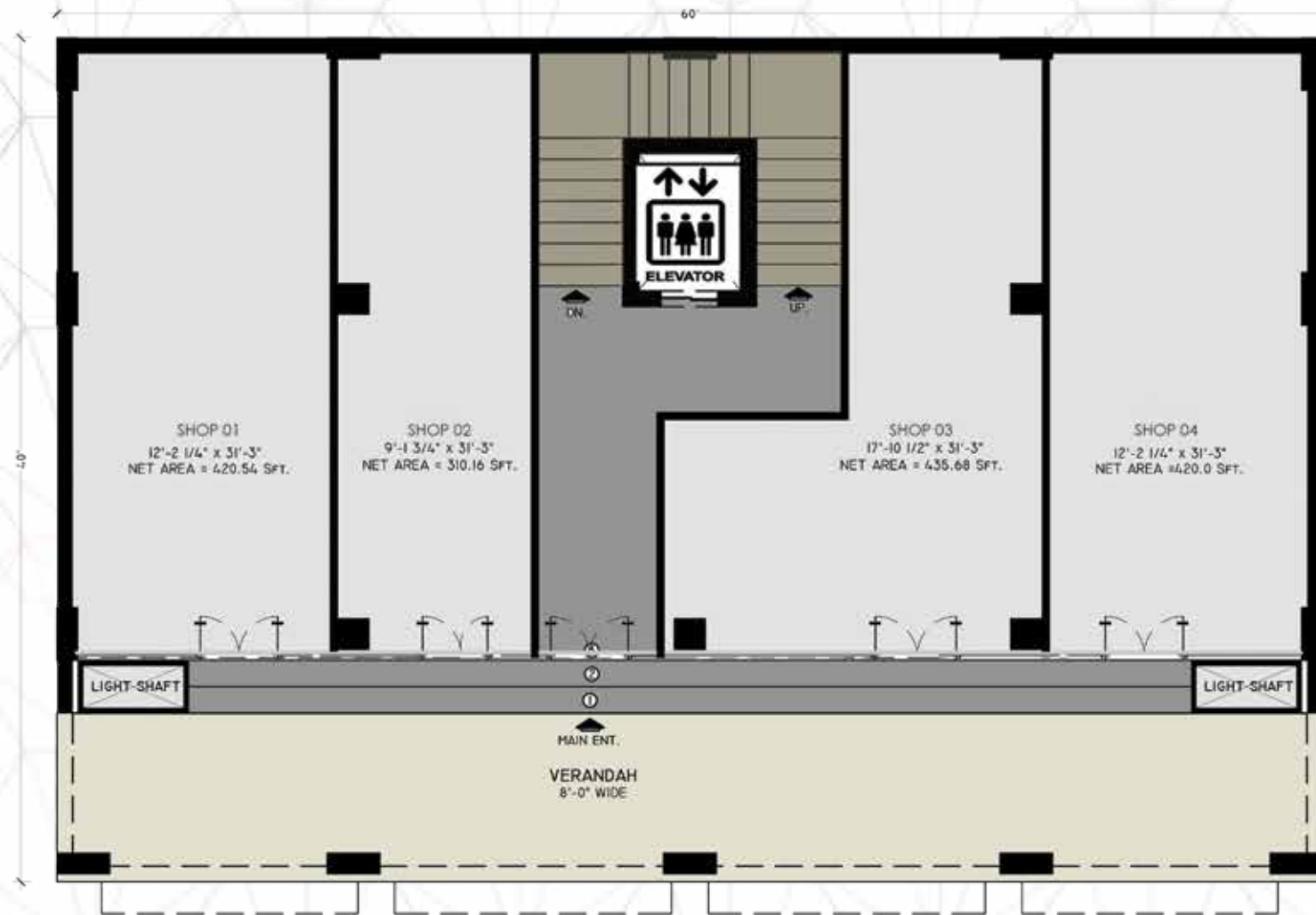

G.F. PROPOSAL PLAN

AREA = 2400.00SFT.
SCALE 3/16"=1'-0"

Shop 01

Total Price - Rs 9,433,200/-
Down Payment (35%) - Rs 3,301,620/-
6 Equal Quarterly installments= Rs 1,021,930/-

Shop 03

Total Price - Rs 9,770,100/-
Down Payment (35%) - Rs 3,419,535/-
6 Equal Quarterly installments= Rs 1,058,428/-

Shop 02

Total Price - Rs 6,962,600/-
Down Payment (35%) - Rs 2,346,910/-
6 Equal Quarterly installments= Rs 754,282/-

Shop 04

Total Price - Rs 9,433,200/-
Down Payment (35%) - Rs 3,301,620/-
6 Equal Quarterly installments= Rs 1,021,930/-

1ST TO 6TH FLOOR PLAN

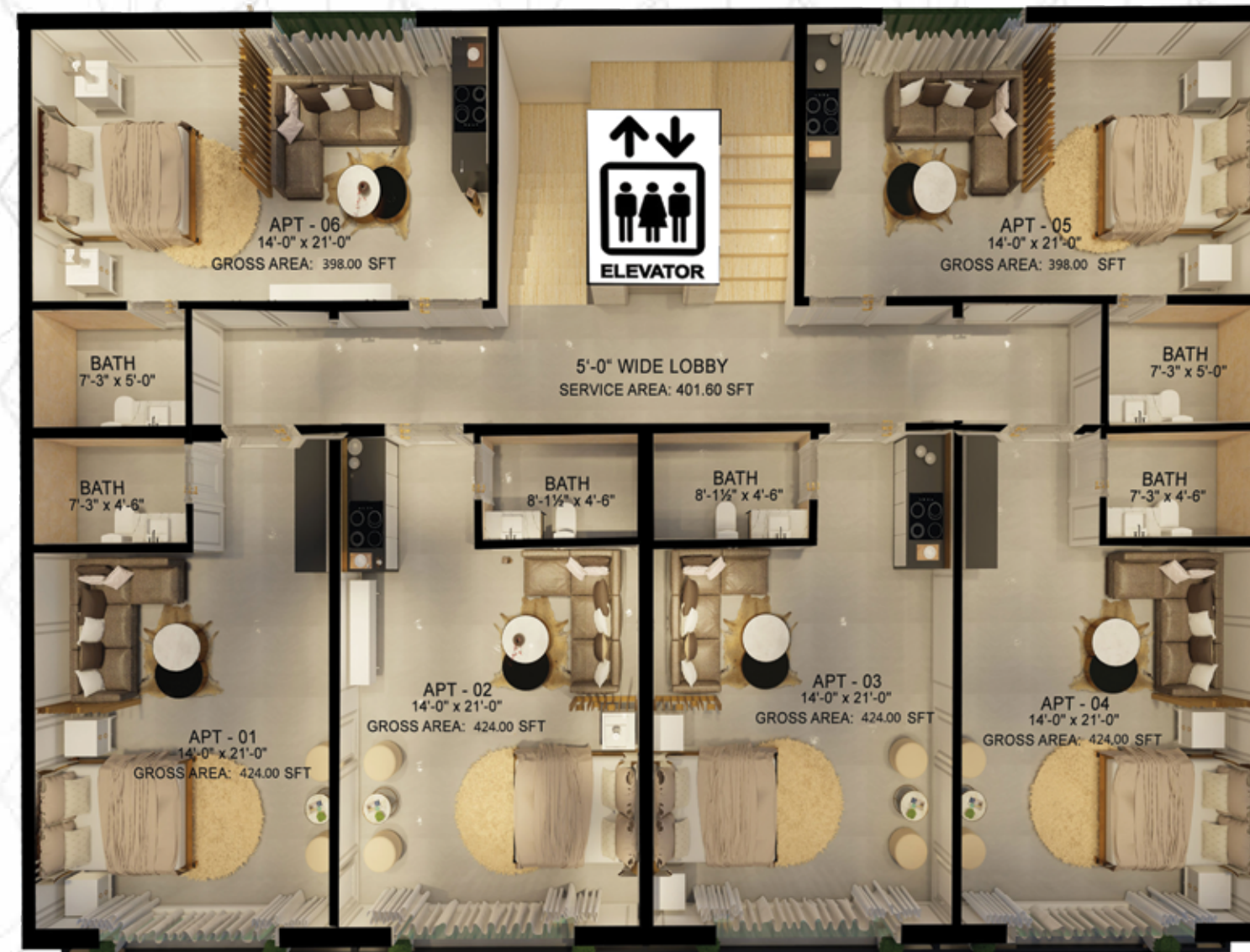

TYPE-A to D

APARTMENT

Gross Area = 424 SQFT

PAYMENT PLAN

Total Price = **6,100,000/-**

35% Down Payment = **2,135,000/-**

6 quarterly instalments = **660,833/-**



SIZE

APARTMENT = 14'-0" X 21'-0"

BATH = 7'-3" X 4'-6"



TYPE-E & F

APARTMENT

Gross Area = 398 SQFT

PAYMENT PLAN

Total Price= **5,725,000/-**

35% Down Payment= **2,003,750/-**

6 quarterly instalments= **620,208/-**



SIZE

APARTMENT= 14'-0" X 21'-0"

BATH= 7'-3" X 5'-0"



The living area, luxuriously designed with french paneling adds up to ambience of the space.



The classical style living area along with metal screen and luxury furniture adds up to the aesthetics of space.



Another view of the living area and bedroom can be seen



The classical style bedroom can be seen with classical paneling on the walls and a feature wall to increase the ambience of space.



The living area, luxuriously designed with french paneling adds up to ambience of the space.



The classical style living area along with metal screen and luxury furniture adds up to the aesthetics of space.



Another view of the living area and bedroom can be seen



The classical style bedroom can be seen with classical paneling on the walls and a view of window can be seen.

